

# PowerGard®

universal receptacles  
& back boxes

Now cULus listed for use in Canada



Powering Business Worldwide

The background of the entire page is a silhouette of an industrial rig, likely an oil or gas drilling rig, against a clear blue sky. The rig's complex structure of beams, ladders, and platforms is visible, with a worker silhouetted on a platform in the distance.

# Designed for work

Receptacles engineered for real world applications and challenging environments

Whether you are powering lighting fixtures or portable equipment, you need a receptacle solution that stands up to the harsh environmental and physical demands of land-based drilling applications.

PowerGard® receptacles and back boxes meet and exceed your power needs with an easy-install, **universal footprint** suitable for rig maintenance, retrofits and new builds.

# Introducing PowerGard®

Universal receptacles & back boxes for land-based drilling



## Primary application

PowerGard® receptacles are used to supply power to lighting systems and lighting panels on land-based drilling rigs.

## Industry-best ease of installation

- Classified for use with Appleton® U-Line Series
- Easy-to-wire saddle clamp terminals reduce installation time and effort
- Molded-in-place phase/ground markings reduce installation errors

## Best-in-class reliability

- Can handle temperature extremes ranging from -50°C to +55°C where comparable products are not certified to operate
- Epoxy powder coat finish, integral gasket design and stainless steel hardware ensure suitability for NEMA 3RX applications
- Vibration tested at 1G to ensure continuity in high vibration areas
- Rugged Krydon® faceplate stands up to abuse in the field without cracking

## Increased ease of operation

- Positive on-off position identifies when unit has been engaged and disengaged
- Clearly marked operating instructions to eliminate risk of improper operation

## EXCLUSIVE FEATURES

- Extended temperature range: -50°C to +55°C
- Certified for use with Hard Service Cords SOOW, SEOOW and STOOW
- Saddle clamp wire terminals
- NEMA 3RX rating
- Krydon® fiberglass-reinforced polyester faceplate

# Specifications & features

## Electrical ratings

- 15 Amp, 125 VAC
- 20 Amp, 125 VAC
- 20 Amp, 250 VAC

## Environmental ratings

- NEMA 3, 3R, 3RX

## Ambient temperature ratings

- ULus, Group C, D  
-50°C to +55°C
- cUL, Group C, D  
-50°C to +40°C
- ULus, Group B, C, D  
-25°C to +55°C
- cUL, Group B, C, D  
-25°C to +40°C

## Certifications and compliances

- NEC & CEC
  - Class I, Groups B\*, C, D
  - Class II, Groups F, G
  - Class III

\* Group B certification not applicable to double gang assemblies. Reference page 6 for full details.
- UL Standards
  - UL 1203 Explosionproof and Dust-Ignition-proof Electrical Equipment for Use in Hazardous (Classified) Locations
- CSA Standard
  - CSA 22.2 No. 30 Explosionproof Enclosures for Use in Class I Hazardous Locations
  - CSA 22.2 No. 159 Attachment plugs, Receptacles, and similar Wiring Devices for Use in Hazardous Locations: Class I, Groups A,B,C,D; Class II Group G, in Coal or Coke Dust, and in Gaseous Mines.
- cULus File #10289

## Standard materials

- Housing, covers and back boxes: Copper-free aluminum with Corro-free™ epoxy powder coat
- Insulator and faceplate: Krydon® fiberglass-reinforced polyester material
- External hardware: Stainless steel

## UNIVERSAL FOOTPRINT

- Provides field flexibility for retrofits or installation in tight places
- UL classified for use with Appleton® U-Line Series

## SUPERIOR HARDWARE

- Stainless steel external hardware eliminates corrosion on critical components and extends product life
- Hex-head screws allow for easy achievement of specified torque values

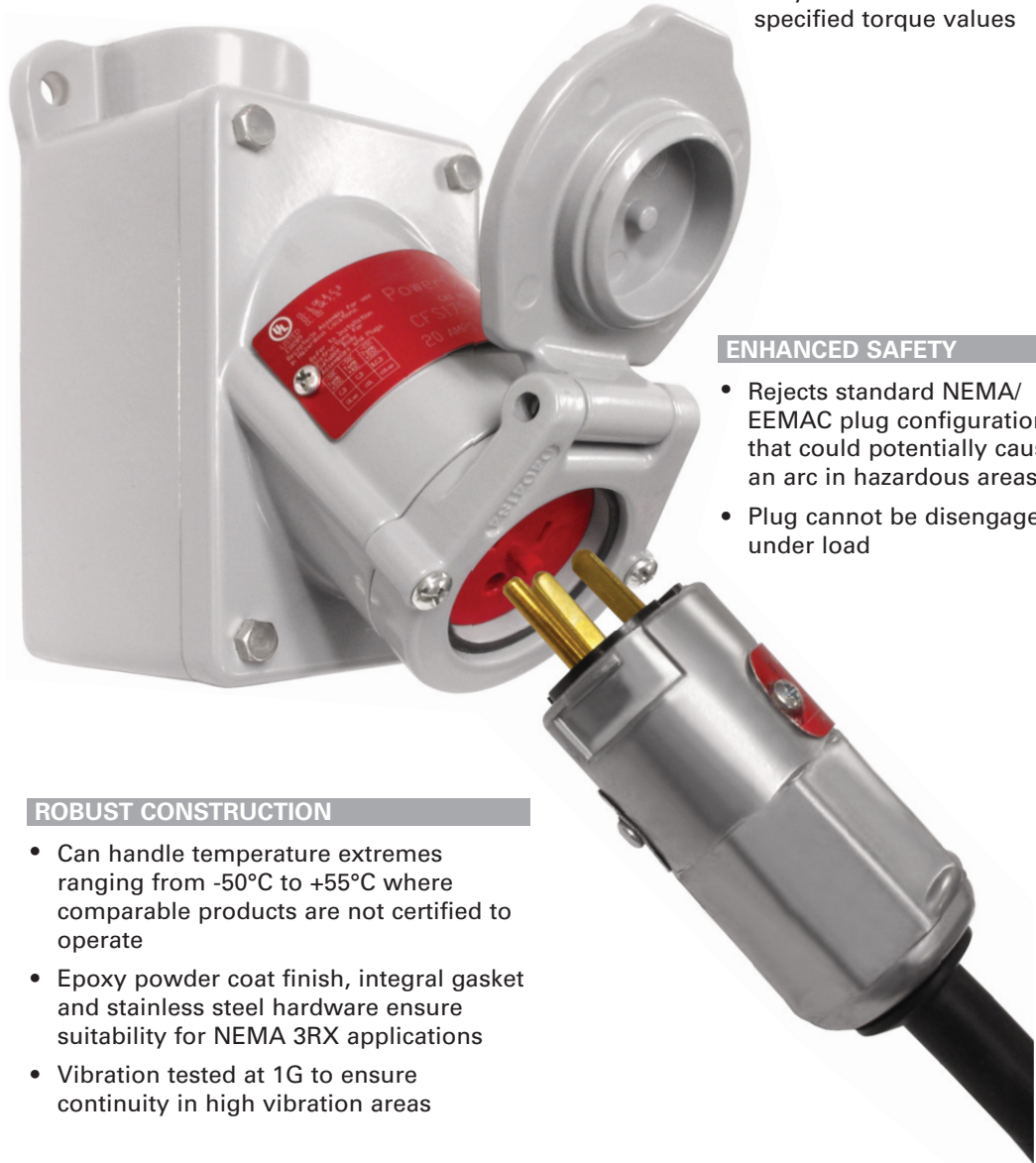

## ENHANCED SAFETY

- Rejects standard NEMA/EEMAC plug configurations that could potentially cause an arc in hazardous areas
- Plug cannot be disengaged under load

## ROBUST CONSTRUCTION

- Can handle temperature extremes ranging from -50°C to +55°C where comparable products are not certified to operate
- Epoxy powder coat finish, integral gasket and stainless steel hardware ensure suitability for NEMA 3RX applications
- Vibration tested at 1G to ensure continuity in high vibration areas

## Dimensions

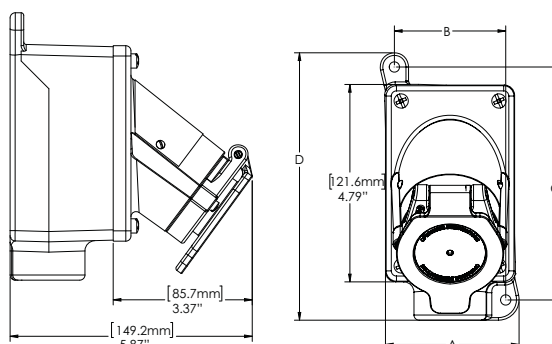

Box Style	A	B	C	D
<b>Single Gang</b>	3.24" [82.3]	2.70" [68.6]	5.65" [143.5]	6.48" [164.7]
<b>Double Gang</b>	6.38" [162.2]	5.50" [139.7]	5.69" [144.4]	6.55" [166.5]



#### SAFESPRING FACEPLATE

- Spring loaded faceplate design prevents receptacle from being energized without use of UL certified hazardous location plug
- Rugged Krydon® faceplate won't crack after continued use in the field



#### EASY-INSTALL TERMINALS

- Molded-in-place phase and ground markings reduce installation errors
- Easy-to-wire saddle clamp terminals reduce installation time and effort
- Receptacle suitable for tough feed/loop wiring; no additional wire nuts or terminators needed

#### Wire Sizes

<b>Solid</b>	16-10 AWG
<b>Stranded</b>	16-12 AWG

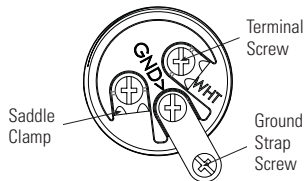

#### BEST-IN-CLASS COVER

- Combo head, stainless steel screws make replacement easy
- Clearly marked operating instructions ensure proper operation and safety when plugging and unplugging
- Threaded cover option available for exceptional watertight integrity



# Ordering information

## Receptacle & Mounting Box



Type	Config.	Wire Pole	Hub Size	20 AMP 125 VAC	20 AMP 250 VAC	15 AMP 125 VAC
Single Gang Assembly *	Dead-end	2W, 3P	1/2	CFS150-2023-M15	CFS150-20232-M15	CFS150-1523-M15
			3/4	CFS175-2023-M15	CFS175-20232-M15	CFS175-1523-M15
			1	CFS110-2023-M15	CFS110-20232-M15	CFS110-1523-M15
	Thru-feed	2W, 3P	1/2	CFSC150-2023-M15	CFSC150-20232-M15	CFSC150-1523-M15
			3/4	CFSC175-2023-M15	CFSC175-20232-M15	CFSC175-1523-M15
			1	CFSC110-2023-M15	CFSC110-20232-M15	CFSC110-1523-M15
Double Gang Assembly **	Dead-end	2W, 3P	1/2	CFS250-2023-M15	CFS250-20232-M15	CFS250-1523-M15
			3/4	CFS275-2023-M15	CFS275-20232-M15	CFS275-1523-M15
			1	CFS210-2023-M15	CFS210-20232-M15	CFS210-1523-M15
	Thru-feed	2W, 3P	1/2	CFSC250-2023-M15	CFSC250-20232-M15	CFSC250-1523-M15
			3/4	CFSC275-2023-M15	CFSC275-20232-M15	CFSC275-1523-M15
			1	CFSC210-2023-M15	CFSC210-20232-M15	CFSC210-1523-M15

\* Single gang assembly listed for Class I, Division 1, Groups B, C, D for -25°C ambient and Class I, Division 1, Groups C, D for -50°C ambient.

\*\* Double gang assembly Listed for Class I, Division 1, Groups C and D, Class I, Division 2, Groups B, C, and D. Manufacturer self certification of Class I, Division 1, Group B available.

## Replacement Receptacle



Type	Wire Pole	20 AMP 125 VAC **	20 AMP 250 VAC **	15 AMP 125 VAC **
Replacement Receptacle *	2W, 3P	*CFSR-2023-M15	CFSR-20232-M15	*CFSR-1523-M15

\* In order to be certified for Class I, Division 1, Group B applications, receptacles must be used on a single gang back box (part # CFD1XX or CFDC1XX)

\*\* Both 15A/125 VAC and 20A/125 VAC PowerGard receptacles can accept either a 15A/125 VAC or 20A/125 VAC ENP plug.

## ENP ArkGard® Plug



Type	Wire Pole	20 AMP 125 VAC	20 AMP 250 VAC	15 AMP 125 VAC
ENP Standard Plug	2W, 3P	ENP5201	ENP6202	ENP5151

## Back Box



Type	Config.	Hub Size	Back Box
Single Gang *	Dead-end	1/2	CFD150
		3/4	CFD175
		1	CFD110
	Thru-feed	1/2	CFDC150
		3/4	CFDC175
		1	CFDC110



Type	Config.	Hub Size	Back Box
Double Gang	Dead-end	1/2	CFD250
		3/4	CFD275
		1	CFD210
	Thru-feed	1/2	CFDC250
		3/4	CFDC275
		1	CFDC210

## Replacement Parts



Type	Cover
Spring Cover Replacement	PGSCA



Type	Cover
Threaded Cover Replacement	PGTCA

Type	Config.
Back Box Hex Bolt Replacement	PG SCREW PACK
Replacement	PG SCREW PACK SLOT

- 1 Derrick/Mast
- 2 VFD/Generators
- 3 Fuel Tank
- 4 Motor Control/VFD/SCR House
- 5 Doghouse/ Operator's House
- 6 Power/Pump Station
- 7 Shale Shaker
- 8 Mud Tanks/Pumps
- 9 Drawworks & Top Drive
- 10 Drilling Floor

# Full portfolio of land-based powering solutions

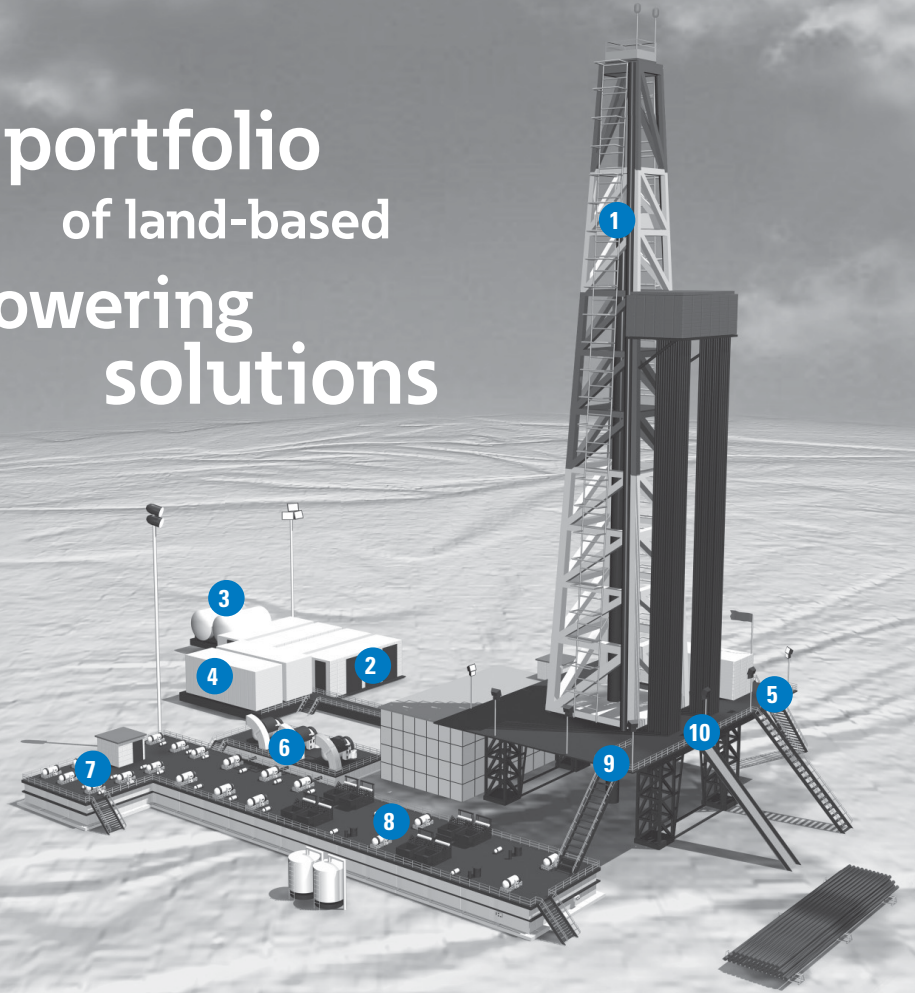

## Crouse-Hinds drilling solutions

### Single pole power

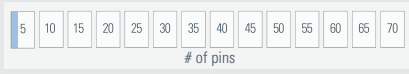

#### Roughneck™ Single Pole Series



Secure, single pole power, rated to 1135A for use in hazardous and normal locations. Ideal for delivering power to the top drive.

**Rig Location**  
1, 2, 4, 5, 6, 9, 10

#### Roughneck™ Quick Connect



Quick connect, high amperage, single conductor connectors built to take heavy abuse while providing a simple, secure and safe connection.

**Rig Location**  
2, 4, 5, 6, 9, 10

#### Cam-Lok™ Single Pole Series



Quickly connect and disconnect power systems safely. Used for motors, generators, indoor and outdoor lighting distribution panels and numerous other power applications.

**Rig Location**  
1, 2, 4, 5, 6, 9, 10

### Low to medium amp power

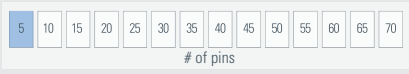

#### PowerGard® Series



Supplies power to lighting systems, lighting panels and portable hand tools on land-based rigs.

**Rig Location**  
1, 2, 3, 4, 5, 6, 7, 8, 9, 10

#### PowerMate™ Series



Supplies power to portable devices such as motor generator sets, compressors, heating and cooling, welders and lighting from 30 to 200A.

**Rig Location**  
2, 4, 5

#### IEC 309 GHG 51 Series



Supplies power to portable devices with requirements of 16 to 125A and features an integrated AC3 rated disconnect switch. Reinforced polyester construction offers reliability from -20° to +55°C.

**Rig Location**  
7, 8, 9

### Multi-pin control

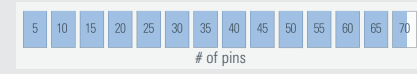

#### Roughneck™ Multi-pin Series



Heavy duty control and instrumentation multi-pin connectors for hazardous and harsh industrial use.

**Rig Location**  
1, 2, 4, 5, 6, 9, 10

#### Connectors for harsh/heavy industrial areas



#### Connectors for hazardous areas



